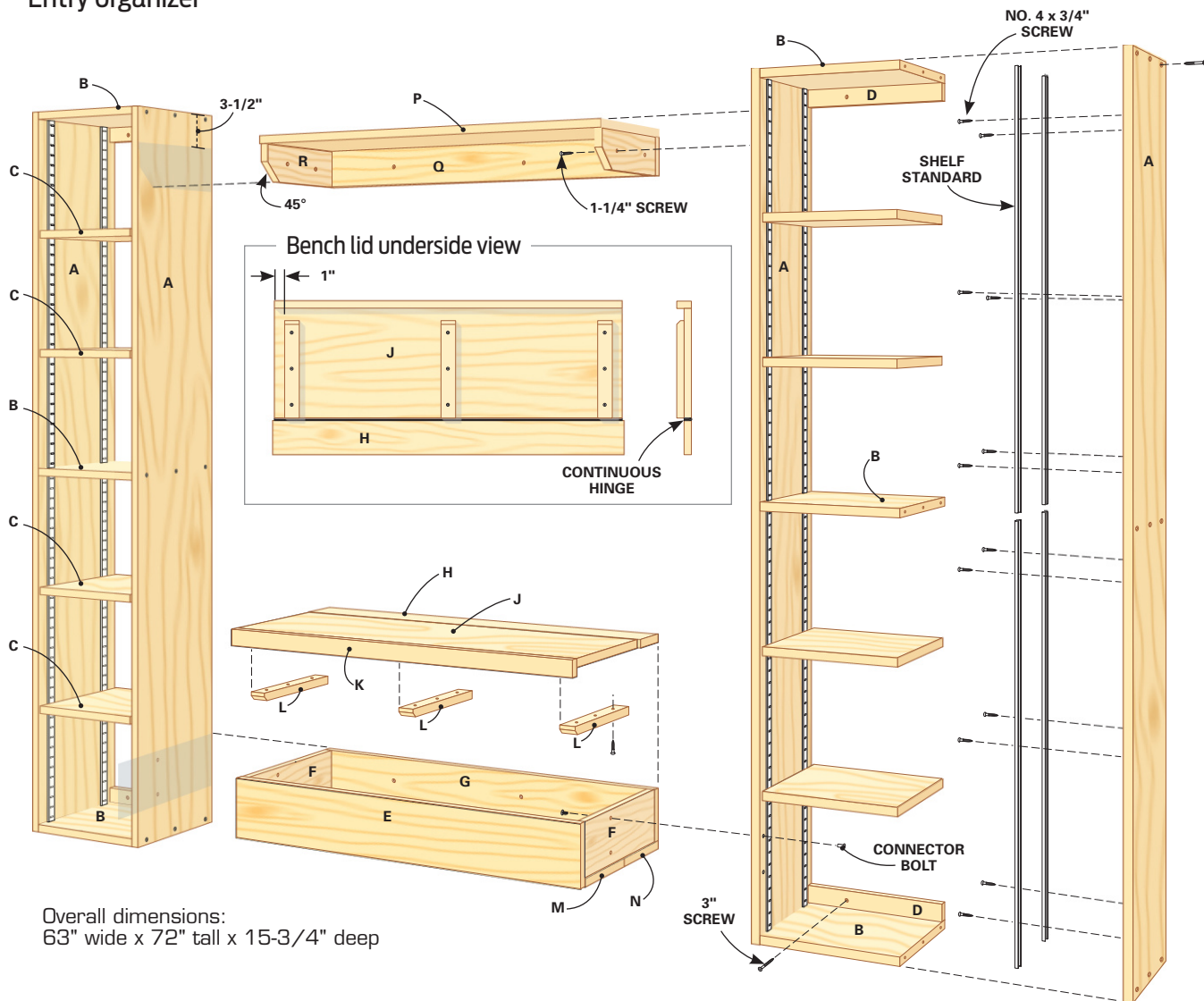

Figure A
Entry organizer



Overall dimensions:
63" wide x 72" tall x 15-3/4" deep

Materials List

ITEM	QTY.
1x12 x 8' standard pine boards	6
1x8 x 6' standard pine boards	1
1x6 x 10' standard pine boards	1
1x4 x 8' standard pine boards	1
1x2 x 10' standard pine boards	1
Hardware	
2" trim-head screws	100
1-1/4" screws	14
3" cabinet screws	10
No. 4 x 3/4" screws (for shelf standards)	Sm. box
1-1/2" connector bolts	4
1-1/2" x 36" continuous hinge	1
72" shelf standards	8
Shelf clips	32
Coat hooks	
Wood filler and 100-grit sandpaper	

Cutting List

KEY	DIMENSIONS	QTY.	NAME
A	3/4" x 11-1/4" x 72"	4	Sides
B	3/4" x 11-1/4" x 12"	6	Top, bottom, middle shelf
C	3/4" x 11-1/4" x 11-5/8"	8	Shelves
D	3/4" x 1-1/2" x 12"	4	Hanging strips
E	3/4" x 5-1/2" x 36"	1	Bench front
F	3/4" x 4-3/4" x 13-1/4"	2	Bench sides
G	3/4" x 4-3/4" x 36"	1	Bench back
H	3/4" x 3-1/2" x 36"	1	Bench top (back)
J	3/4" x 11-1/4" x 35-5/8"	1	Bench top lid
K	3/4" x 1-1/2" x 35-5/8"	1	Bench lid nosing
L	3/4" x 1-1/2" x 10"	3	Bench seat cleats
M	3/4" x 7-1/4" x 36"	1	Bench bottom
N	3/4" x 6-3/4" x 36"	1	Bench bottom
P	3/4" x 11-1/4" x 36"	1	Top shelf
Q	3/4" x 3-1/2" x 36"	1	Top shelf back rail
R	3/4" x 3-1/2" x 10-1/4"	2	Top shelf side rail

WHAT IT TAKES

TIME: One weekend
COST: \$150
SKILLS: Beginner
TOOLS: Tape measure, large square, level, cordless drill, drill bits, circular saw, hacksaw, clamps.