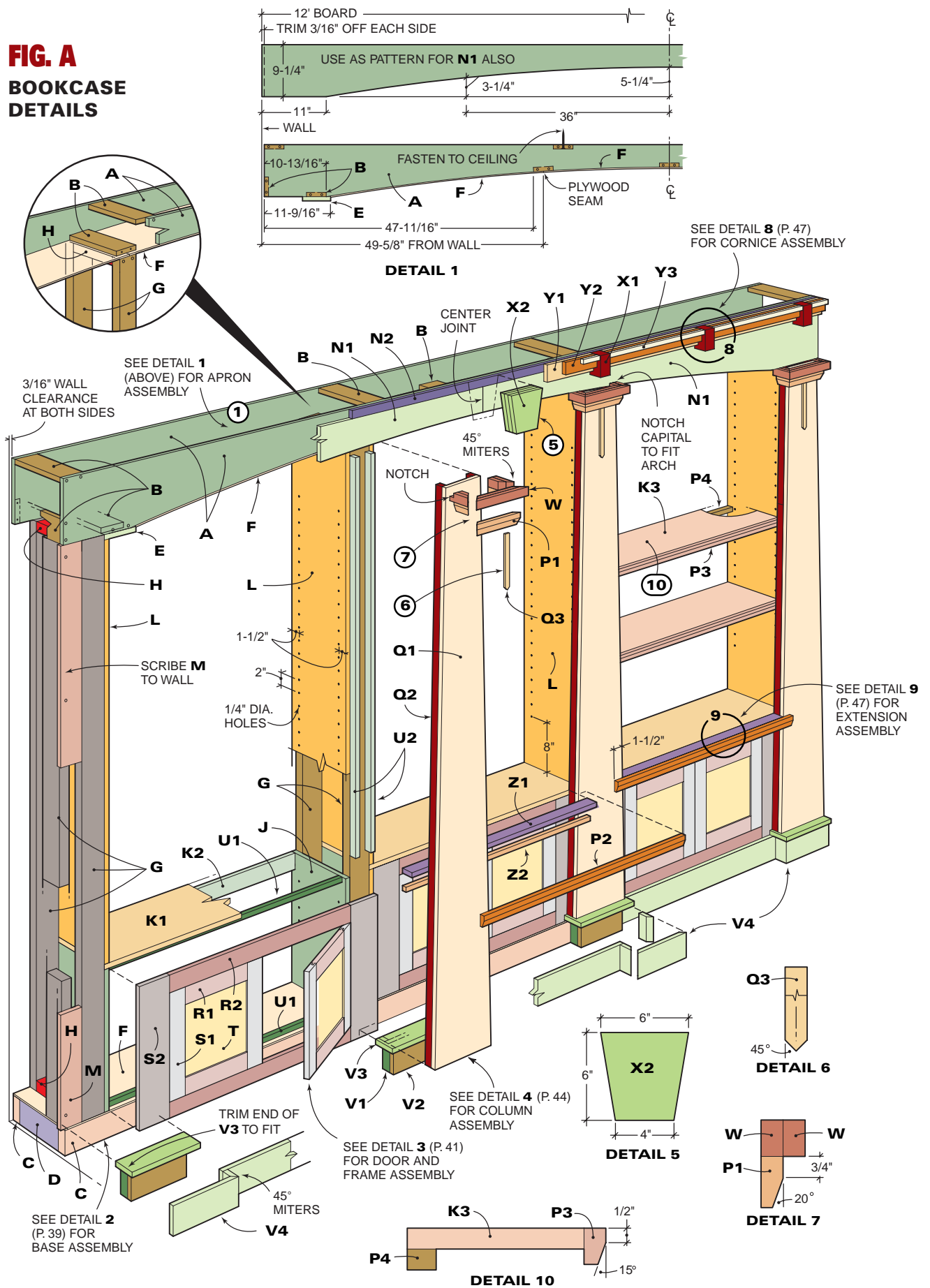

FIG. A
BOOKCASE
DETAILS



Cutting List

KEY	QTY.	SIZE & DESCRIPTION	KEY	QTY.	SIZE & DESCRIPTION
A	2	3/4" x 9-1/4" x 144" pine arch (cut to fit)	P4	12	3/4" x 1" x 40" oak shelf back reinforcing slat (cut to fit)
B	11	3/4" x 3-1/2" x 10-3/8" cross ties	Q1	4	3/4" x 10" x 87" oak column blanks
C	2	1-1/2" x 3-1/2" x 144" 2x4 base (cut to fit)	Q2	8	3/4" x 1-1/4" x 87" oak column sides
D	9	1-1/2" x 3-1/2" x 8-7/8" 2x4 cross ties	Q3	4	5/16" x 3/4" x 8" oak daggers
E	2	3/4" x 5" x 11-7/8" oak fillers	R1	12	3/4" x 2-1/2" x 11" oak door rails
F	3	1/4" x 11-7/8" x 96" oak plywood ribs (cut to fit)	R2	6	3/4" x 2-1/2" x 30" oak face frame rails
G	10	1-1/2" x 3-1/2" x 96" vertical supports (cut to fit)	S1	12	3/4" x 2-1/2" x 15" oak door stiles
H	8	1-1/2" x 3-1/2" x 8-7/8" 2x4 filler blocks	S2	6	3/4" x 4-3/4" x 20" oak face frame stiles
J	6	3/4" x 11-7/8" x 20" oak plywood cabinet sides	T	6	1/4" x 10-7/8" x 10-7/8" oak plywood door panels
K1	3	3/4" x 11-7/8" x 41-1/2" oak plywood cabinet tops (cut to fit)	U1	6	3/4" x 3/4" x 39-1/2" pine face frame cleats
K2	3	3/4" x 2-1/2" x 40" pine cleats (cut to fit)	U2	8	3/4" x 1-1/4" x 60" pine upper column backers
K3	12	3/4" x 10-3/4" x 40" oak plywood shelf blanks (cut to fit)	V1	4	1-1/2" x 4" x 8-1/2" pine column base fillers
L	6	3/4" x 11-7/8" x 70" oak plywood bookcase sides (cut to fit)	V2	4	3/4" x 4" x 8-1/2" pine column base fillers
M	2	3/4" x 3-1/4" x 84" oak filler boards (cut to fit)	V3	4	3/4" x 3-1/2" x 11" oak column plinths
N1	1	3/4" x 9-1/4" x 144" oak arch (cut to fit)	V4	16 ft.	3/4" x 4" oak baseboards
N2	1	3/4" x 1-1/4" x 144" pine filler (cut to fit)	W	10 ft.	3/4" x 1-1/4" oak capital molding
P1	6 ft.	3/4" x 1-3/4" oak capital face molding (cut to fit)	X1	6	2-1/4" x 2" x 3-1/2" oak cornice blocks
P2	12 ft.	3/4" x 1-1/2" cabinet top front molding (cut to fit)	X2	1	2-1/4" x 6" x 6" oak keystone
P3	12	3/4" x 1-1/4" x 40" oak shelf nosing molding (cut to fit)	Y1	12 ft.	3/4" x 2-3/4" oak cornice molding (cut to fit)
			Y2	12 ft.	3/4" x 2" oak cornice molding (cut to fit)
			Y3	12 ft.	3/4" x 5/8" oak cornice molding (cut to fit)
			Z1	3	3/4" x 2" x 39" oak plywood cabinet top extensions (cut to fit)
			Z2	3	3/4" x 3/4" x 39" pine top extension cleats (cut to fit)

Shopping List

DESCRIPTION	QTY.
1x10 x 12' No. 2 pine arches (A)	2
1x4 x 12' No. 2 pine (B, K2, N2)	3
1x6 x 8' No. 2 pine (Z2, U1, U2, V2)	3
2x4 x 12' pine (C)	2
2x6 x 8' pine (V1)	1
2x4 x 8' pine (G, D, H)	12
1/4" x 4' x 8' oak plywood (F, T)	1
3/4" x 4' x 8' oak plywood (J, L, K1, K3, Z1)	4
1x4 x 8' oak (M, W, V3, X1)	5
1x10 x 12' oak (N1)	1
1x4 x 8' oak (P1, P2, P3, Q2)	8
1x6 x 12' oak (E, P4, Y1, Y2, Y3, R1, R2, S1, S2)	5
1x6 x 8' oak (Q1)	8
1x6 x 16' oak base (V4)	1
1x8 x 2' oak (X2)	1
1/2" x 5-1/2" x 12' cedar siding	1
No-mortise hinges	6 pr.
Shelf clips	48
Wood glue	16 ozs.
1" nails for nail gun	1 pkg.
1-1/2" nails for nail gun	1 pkg.
2" nails for nail gun	1 pkg.
10d casing nails	2 doz.
Knobs and magnet catches for doors	6
Stain	2 qts.
Varnish	3 qts.

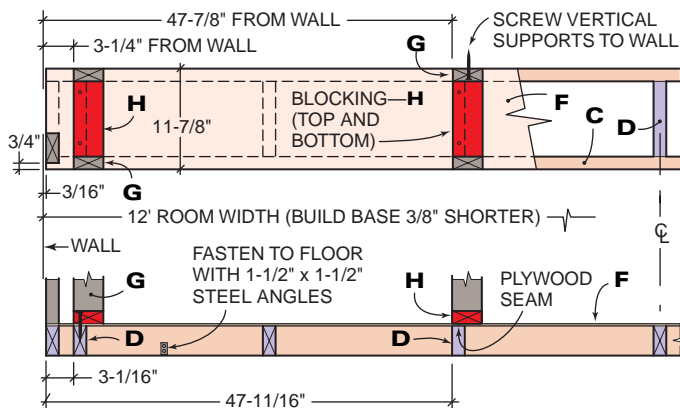

Detail 3 DOOR AND FRAME ASSEMBLY

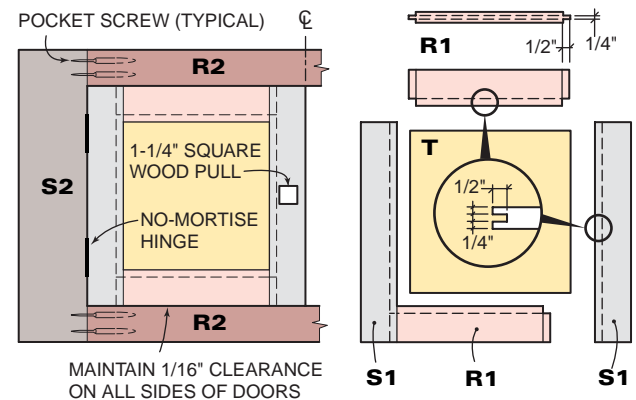

Mission oak
built-in
bookcase



**Detail 4
COLUMN ASSEMBLY**

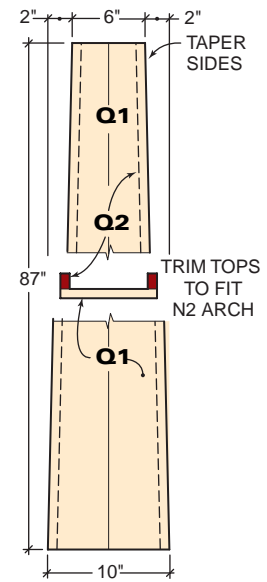

More **BOOKCASE** >>