

Figure A
Basic built-in cabinet

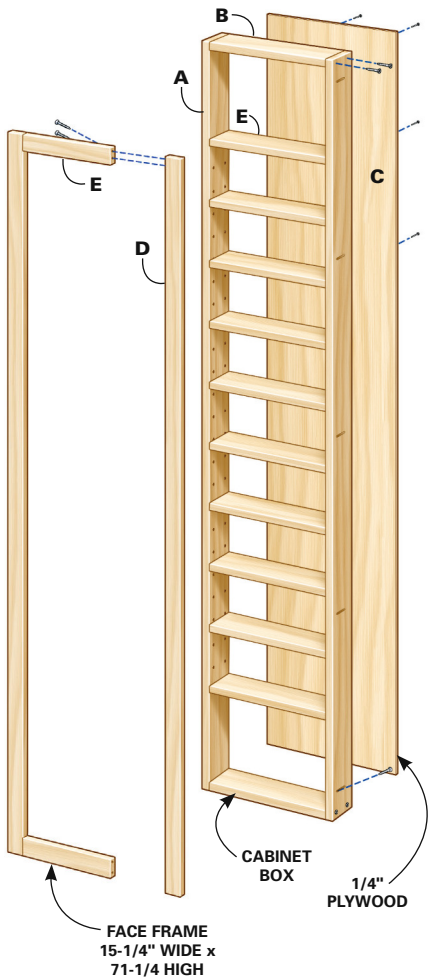
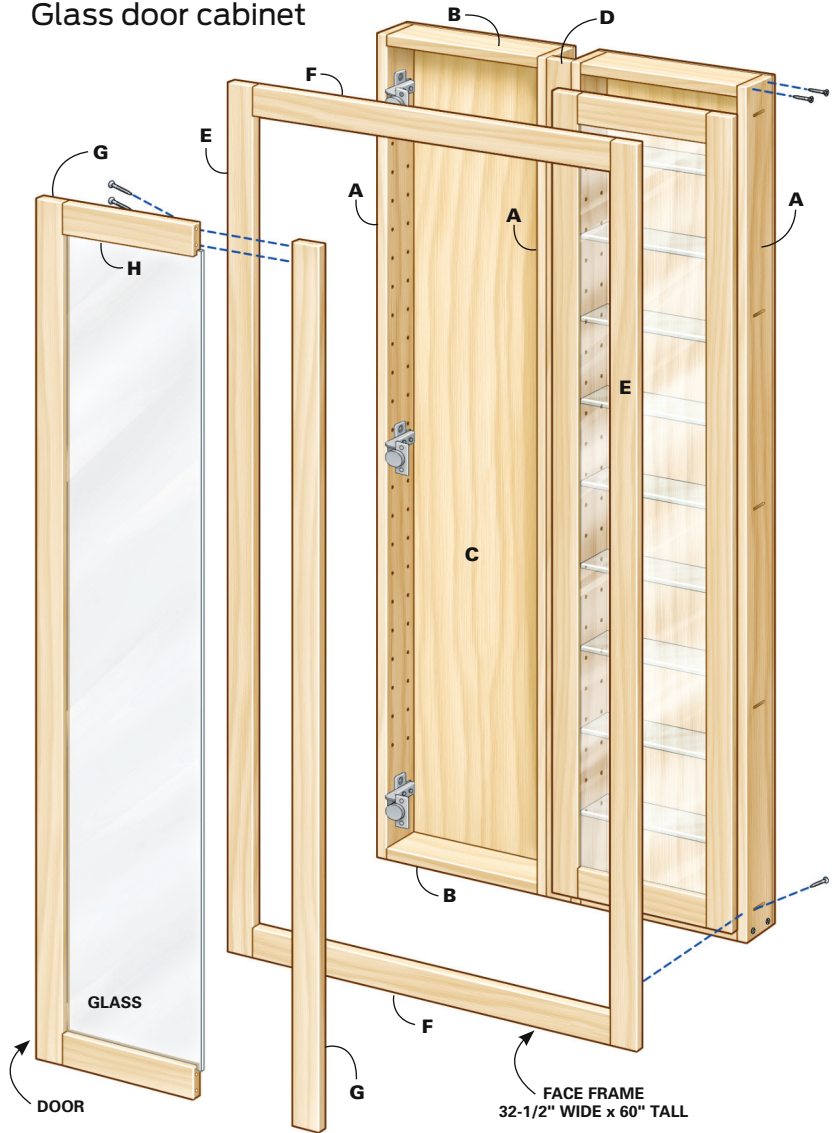

Figure B
Glass door cabinet



Cutting List: Basic built-in

KEY QTY. SIZE & DESCRIPTION

A	2	3/4" x 3-1/2" x 70" sides
B	2	3/4" x 3-1/2" x 12-1/2" top and bottom
C	1	3/4" x 14" x 70" plywood back
D	2	3/4" x 1-1/2" x 71-1/4" face frame stiles
E	2	3/4" x 1-1/2" x 12-1/4" face frame rails
F	10	3/4" x 3-1/2" x 12-3/8" shelves

Materials List: Basic built-in

ITEM	QTY.
1x2 x 8' paint or stain grade lumber	2
1x4 x 8' paint or stain grade lumber	3
2' x 8' x 1/4" plywood	1

Hardware

1/4" shelf supports	40
1-1/2" wood screws	12
1-1/4" pocket hole screws	16
Small package No. 16 x 1" wire nails	1

Cutting List: Glass door cabinet

KEY QTY. SIZE & DESCRIPTION

A	4	3/4" x 3-1/2" x 57-1/2" sides
B	4	3/4" x 3-1/2" x 12-1/2" tops and bottoms
C	2	1/4" x 14" x 57-1/2" plywood backs
D	1	1/2" x 1-1/2" x 57-1/2" mull
E	2	3/4" x 2" x 60" face frame stiles*
F	2	3/4" x 2" x 28-1/2" face frame rails*
G	4	3/4" x 2" x 55-7/8" door stiles*
H	4	3/4" x 2" x 10-1/16" door rails*

*Cut to fit

**You'll be surprised
how much stuff
fits in these
shallow cabinets.**

Materials List: Glass door cabinet

ITEM	QTY.
1x4 x 12' paint- or stain-grade lumber	2
1x6 x 10' paint- or stain-grade lumber (rip to 2")	2
4' x 8' x 1/4" plywood	1

HARDWARE

Blum 110-degree clip top hinge (71B3750)*	6
Blum hinge mounting plates (B175H710)*	6
1/4" shelf supports	72
5/16" clear door bumpers	76
1-1/4" pocket hole screws	40
1-1/2" wood screws	16
Small package No. 16 x 1" wire nails	1

*Online source: Woodworker's Hardware, www.hardware.com

GLASS

Glass for doors: Measure rabbet recess and subtract 1/8" (check local codes regarding the need for safety glass) 2
Glass shelves: Measure width and subtract 1/8" 18